

eC-test-mate Dimensions

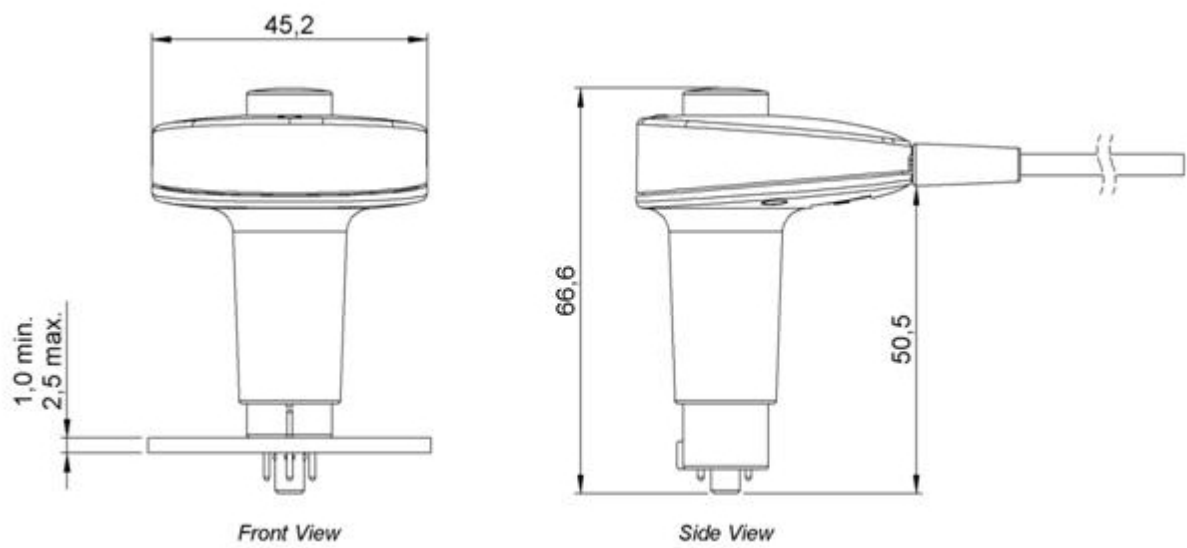

Footprint technical drawings Type I

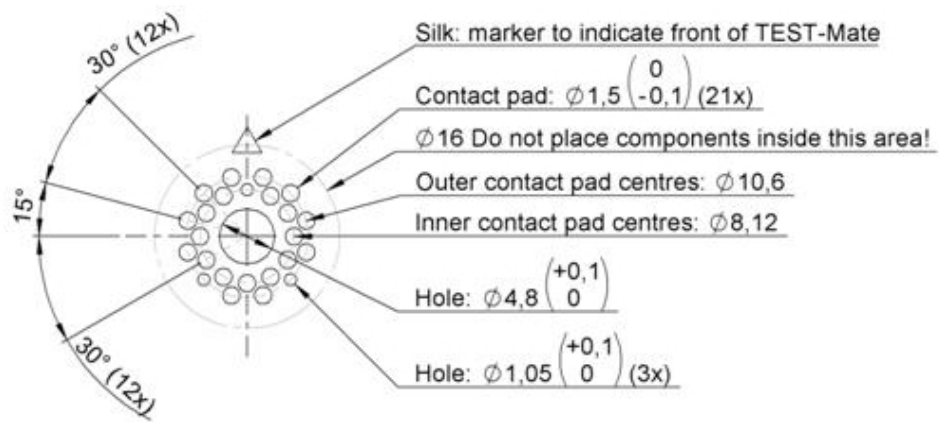

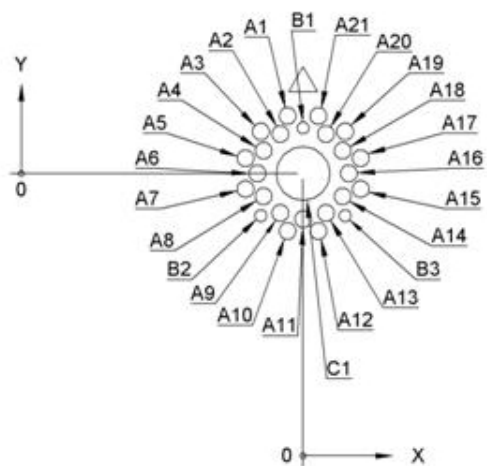

Hole Table			
TAG	X LOC	Y LOC	SIZE
A1	-1.37	5.12	Contact pad: $\phi 1.5$ $\begin{smallmatrix} 0 \\ -0.1 \end{smallmatrix}$
A2	-2.03	3.52	
A3	-3.75	3.75	
A4	-3.52	2.03	
A5	-5.12	1.37	
A6	-4.06	0	
A7	-5.12	-1.37	
A8	-3.52	-2.03	
A9	-2.03	-3.52	
A10	-1.37	-5.12	
A11	0	-4.06	
A12	1.37	-5.12	
A13	2.03	-3.52	
A14	3.52	-2.03	
A15	5.12	-1.37	
A16	4.06	0	
A17	5.12	1.37	
A18	3.52	2.03	
A19	3.75	3.75	
A20	2.03	3.52	
A21	1.37	5.12	
B1	0	4.06	Hole: $\phi 1.05$ $\begin{smallmatrix} +0.1 \\ 0 \end{smallmatrix}$ THRU
B2	-3.75	-3.75	
B3	3.75	-3.75	
C1	0	0	Hole: $\phi 4.8$ $\begin{smallmatrix} +0.1 \\ 0 \end{smallmatrix}$ THRU

Footprint technical drawing Type II

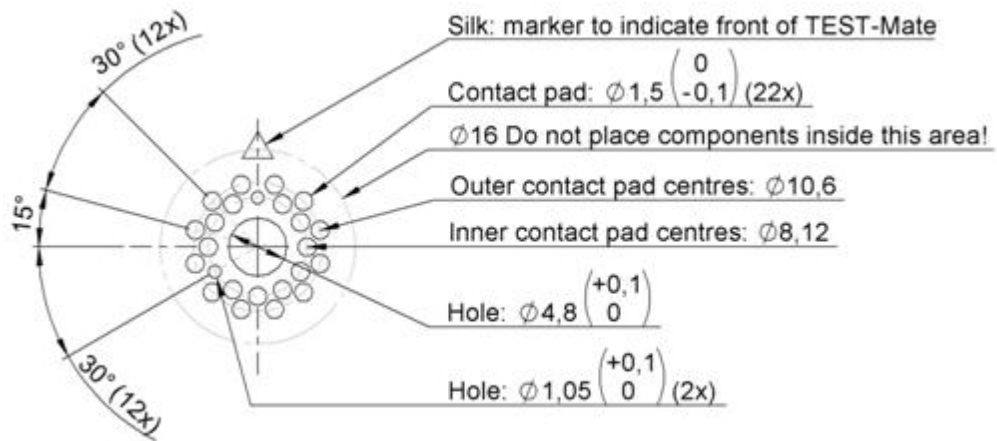

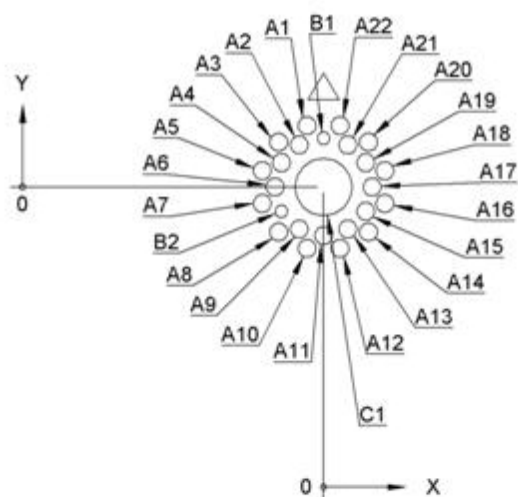

Hole Table			
TAG	X LOC	Y LOC	SIZE
A1	-1,37	5,12	Contact pad: $\varnothing 1,5 -0,1$
A2	-2,03	3,52	
A3	-3,75	3,75	
A4	-3,52	2,03	
A5	-5,12	1,37	
A6	-4,06	0	
A7	-5,12	-1,37	
A8	-3,74	-3,74	
A9	-2,03	-3,52	
A10	-1,37	-5,12	
A11	0	-4,06	
A12	1,37	-5,12	
A13	2,03	-3,52	
A14	3,74	-3,74	
A15	3,52	-2,03	
A16	5,12	-1,37	
A17	4,06	0	
A18	5,12	1,37	
A19	3,52	2,03	
A20	3,75	3,75	
A21	2,03	3,52	
A22	1,37	5,12	
B1	0	4,06	Hole: $\varnothing 1,05$ $\begin{smallmatrix} +0,1 \\ 0 \end{smallmatrix}$ THRU
B2	-3,52	-2,03	
C1	0	0	Hole: $\varnothing 4,8$ $\begin{smallmatrix} +0,1 \\ 0 \end{smallmatrix}$ THRU

Footprint technical drawing Type III

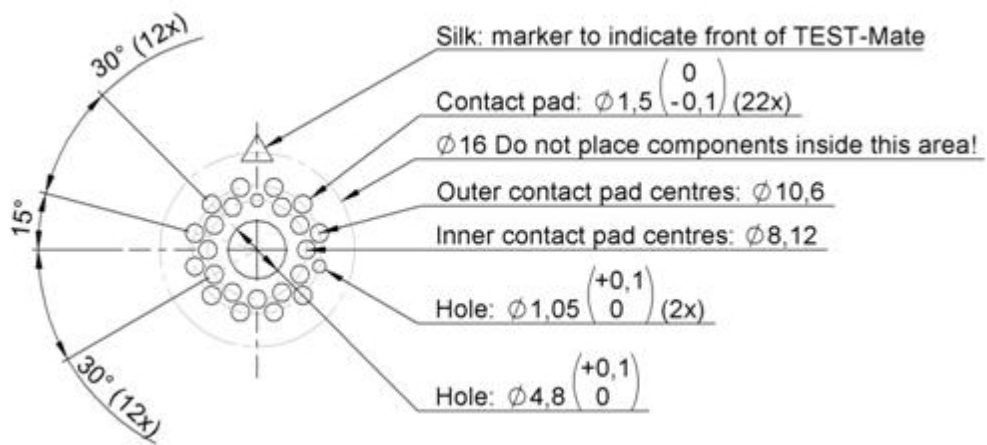

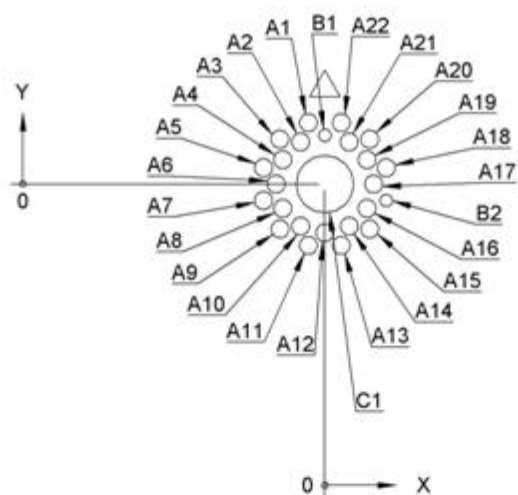

Hole Table			
TAG	X LOC	Y LOC	SIZE
A1	-1,37	5,12	Contact pad: $\varnothing 1,5 - 0,1$
A2	-2,03	3,52	
A3	-3,75	3,75	
A4	-3,52	2,03	
A5	-5,12	1,37	
A6	-4,06	0	
A7	-5,12	-1,37	
A8	-3,52	-2,03	
A9	-3,74	-3,74	
A10	-2,03	-3,52	
A11	-1,37	-5,12	
A12	0	-4,06	
A13	1,37	-5,12	
A14	2,03	-3,52	
A15	3,74	-3,74	
A16	3,52	-2,03	
A17	4,06	0	
A18	5,12	1,37	
A19	3,52	2,03	
A20	3,75	3,75	
A21	2,03	3,52	
A22	1,37	5,12	
B1	0	4,06	Hole: $\varnothing 1,05$ $\begin{smallmatrix} +0,1 \\ 0 \end{smallmatrix}$ THRU
B2	5,12	-1,37	
C1	0	0	Hole: $\varnothing 4,8$ $\begin{smallmatrix} +0,1 \\ 0 \end{smallmatrix}$ THRU